

FOR LEASE

INDUSTRIAL

INDUSTRIAL BUSINESS PARK

GILMAN BUSINESS PARK

INDUSTRY, CA 91746

GILMAN BUSINESS PARK
14145 PROCTOR AVENUE
SUITES 1-29

FEATURES:

- 14145 Proctor Avenue, Industry, CA 91746
- 50,950 Square Foot Industrial Park
- Units from 1,490 to 3,264 Square Feet
- Prime West Industry Location | South of Valley Blvd
- Close Proximity to I-605 and CA-60
- No CAM Fees - Water & Trash Included in Rent
- Located in Unincorporated LA County

EXCLUSIVELY LISTED BY:

TYLER PORTMAN

562.762.3152

tyler@gmpropertiesinc.com

Lic. 01919110

DUSTIN WHEELAN

562.762.3120

dustin@gmpropertiesinc.com

Lic. 01444728

GM 
PROPERTIES

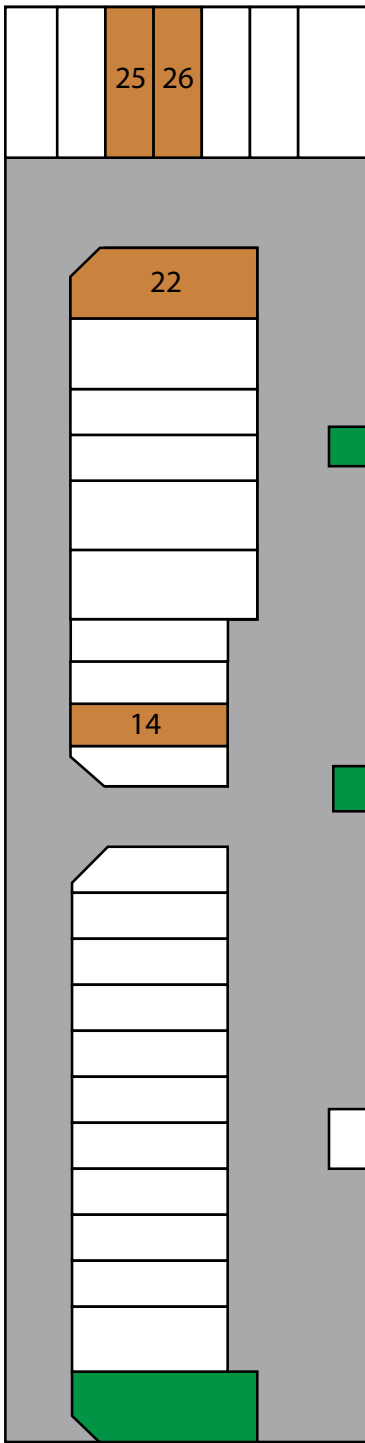

ADDRESS	SIZE	PRICE	AVAILABLE
UNIT 14	1,490 SF	\$1.60/SF GROSS	MAY 1, 2024
UNIT 22	2,924 SF	\$1.60/SF GROSS	MAY 1, 2024
UNIT 25	1,540 SF	\$1.60/SF GROSS	Now
UNIT 26	1,540 SF	\$1.60/SF GROSS	Now

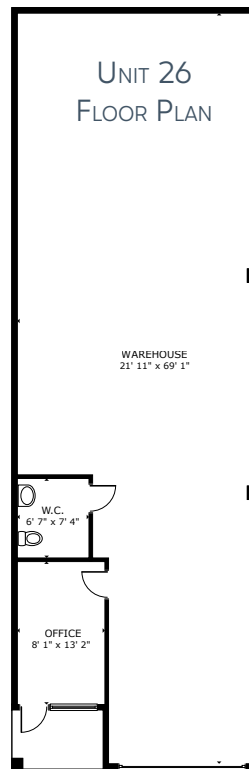

FLOOR PLAN

GROSS INTERNAL AREA
 OFFICE 178 sq.ft.
 WAREHOUSE 1,362 sq.ft.
 TOTAL : 1,540 sq.ft.

SIZES AND DIMENSIONS ARE APPROXIMATE, ACTUAL MAY VARY.

EXCLUSIVELY LISTED BY:

TYLER PORTMAN

562.762.3152

tyler@gmpropertiesinc.com

Lic. 01919110

DUSTIN WHEELAN

562.762.3120

dustin@gmpropertiesinc.com

Lic. 01444728

No warranty, expressed or implied, is made as to the accuracy of the information contained herein. This information is subject to errors, omissions, change of price, sale or other conditions, withdrawal without notice, and is subject to any special listing conditions imposed by our principals. Cooperating brokers, Prospective Buyers and other parties who receive this document should not rely on it, but should use it as a starting point of analysis, and should independently confirm the accuracy of the information contained herein through a due diligence of the books, records, files and documents that constitute reliable sources of the information described herein.

